

After 14+ years in the Holy Name Heights building located at 706 S High Point Rd., Blue Plate Catering, founded in 1993, is excited at the opportunity to move into the building at 5302 Anton Dr. Formerly a furniture store and the potential future site of Little John's kitchen, our growing business needs a new space that we can make our home for the next 14+ years. We were initially drawn to the location because two of our partners attend Redeemer City Church (5356 King James Way), and we like the proximity to a number of our catering clients and main roads.

In order to function as a commercial kitchen, we have been in discussions with contractors to build a commercial kitchen, office space, and small banquet room for our team to continue to serve Fitchburg and the surrounding communities. We would have between 40-50 parking spaces on site, sufficient for our 30+ full time staff. We would bring our existing indoor and outdoor security system.

A typical day has our first chefs arriving at 5:00am, followed by administrative staff at 6:00am. Most days, four catering trucks make 2-3 trips, and production in the kitchen typically ends at 4:00pm, with administrative staff ending at 5:30pm. On average, we have one event per evening in the summer season.

We look forward to answering any questions that you may have, and appreciate your time in considering our application.

Sincerely,

David Porto
President
Blue Plate Catering, Inc.

5302 ANTON DR.

- No change to exterior of building
- Food delivery to use loading dock (🍴)

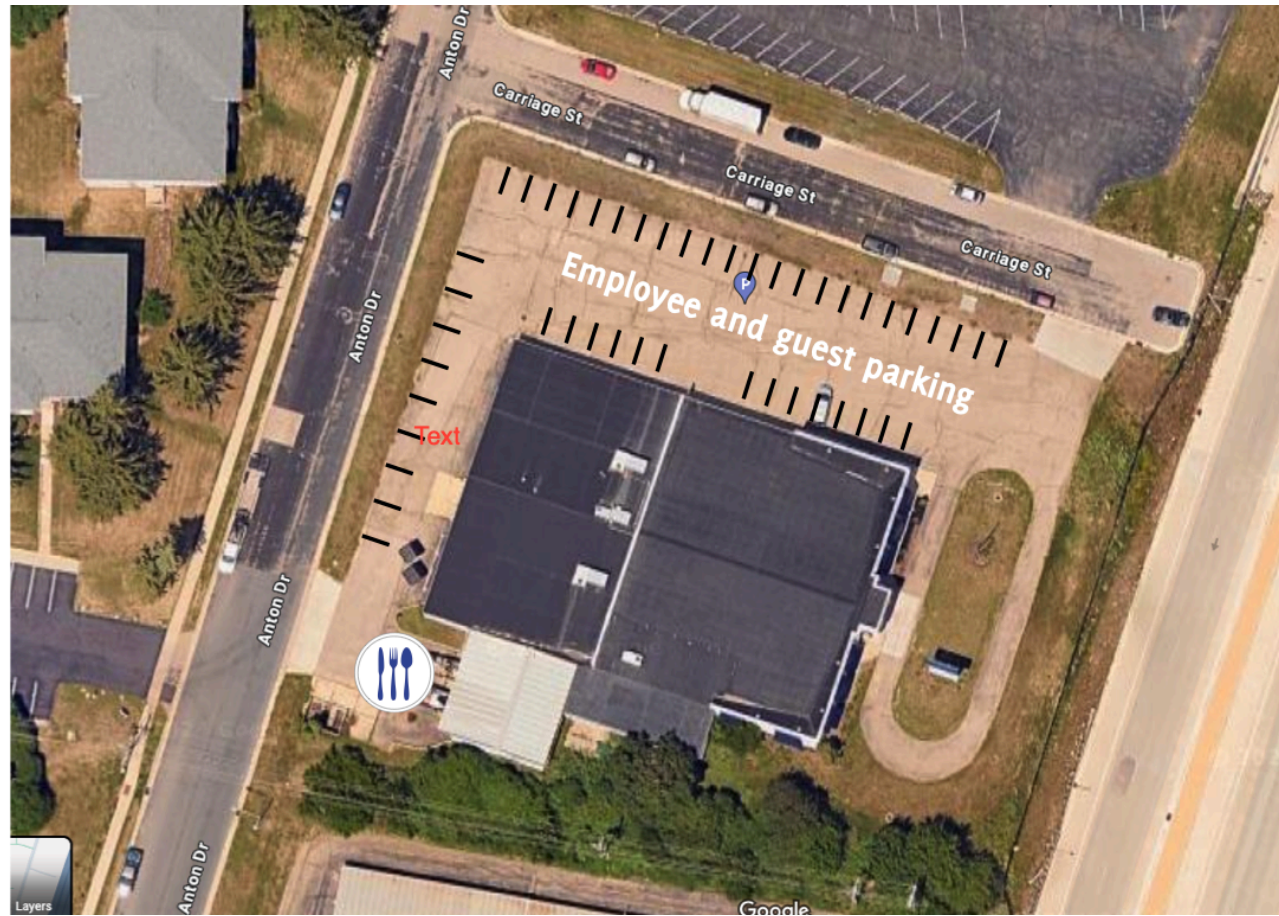

Room	Old SF	New SF	Difference
Kitchen	1,600	2,400	800
Working Kitchen	1,000	"Kitchen"	
Kitchen Trash	100	"Kitchen"	
Cold Prep	325	"Kitchen"	
Kitchen Hallway	175	"Dry Storage"	
Coolers	300	800	500
1	60	"Cooler Space"	
2	65	"Cooler Space"	
3	90	"Cooler Space"	
Freezer	85	"Cooler Space"	
Dish Pit	665	500	-165
Dish Pit	600	"Dish Pit"	
Storage by dish pit	65	"Dish Pit"	
Operations	2,075	2,500	425
Packroom	720	"Ops"	
Ice Room	90	"Walk Thru"	
Laundry	115	"Loading dock"	
Bar	230	"Pre Existing Off"	
Loading	200	"Walk Thru"	
Shed	600	"Storage"	"Garage"
Uniforms	70	"Closet"	
Beer / Soda	50	"Beer Cooler"	
Office	2,000	2,000	0
Entry/Emily	355	"Pre Existing Off"	
Gary	100	"Offices"	
Ben/Jon	200	"Pre Existing Off"	
Ashley	130	"Offices"	
Tasting	150	"Tasting Suite"	
Kitchen Office	150	"Pre Existing Off"	
David	200	"Offices"	
Autumn	115	"Offices"	
Michael / Emily	600	"Pre Existing Off"	

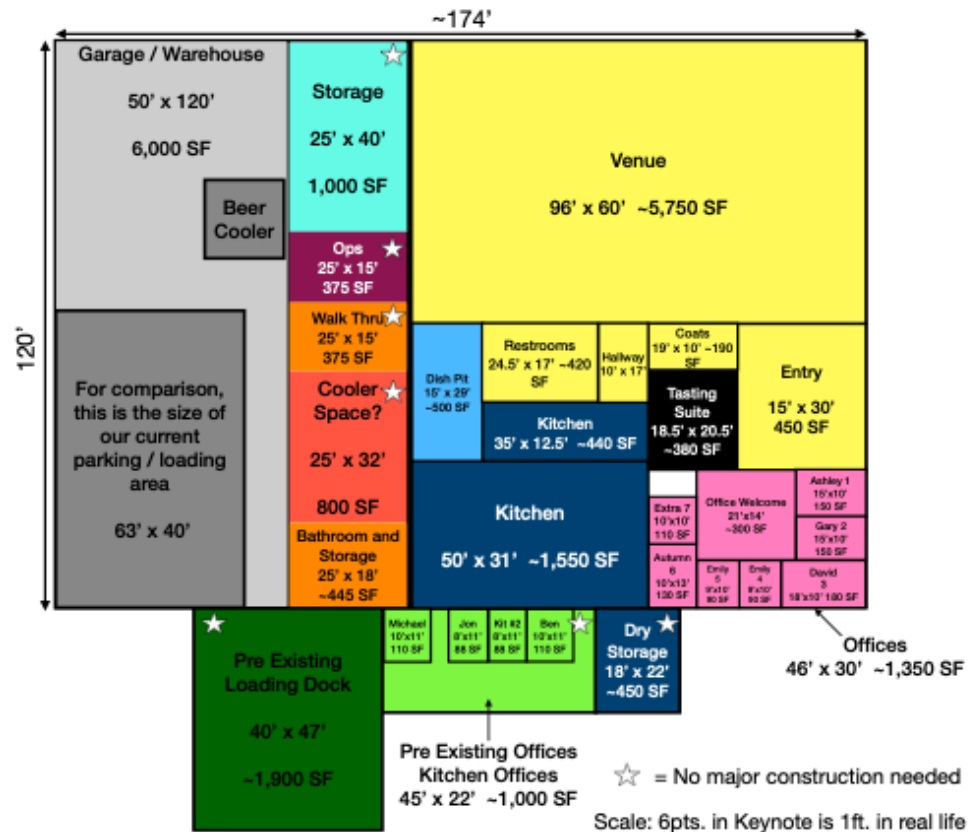

Document Details

Title	5302 Conditional Use Summary.pdf
File Name	5302 Conditional Use Summary (2).pdf
Document ID	71dc612f0ed641f395346c1b29975df1
Fingerprint	223a505dedc1d5e8dbcb1ddca76245df
Status	Completed

Document History

Document Created	Document Created by David Porto (contact@blueplatecatering.com) Fingerprint: c0638f26c6835ff0ae41b66d3495fb9a	Jul 19 2024 03:35PM America/Chicago
Document Signed	Document Signed by David Porto (contact@blueplatecatering.com) IP: 96.60.1.153  president	Jul 19 2024 03:35PM America/Chicago
Document Completed	This document has been completed. Fingerprint: 223a505dedc1d5e8dbcb1ddca76245df	Jul 19 2024 03:35PM America/Chicago



Conditional Use - Owner or Authorized Agent Acknowledgement

** It is highly recommended that an applicant hold at least one neighborhood meeting prior to submitting a CUP application to identify any concerns or issues of surrounding residents.

PLEASE NOTE - Applicants shall be responsible for legal or outside consultant costs incurred by the City. Submissions shall be made at least four (4) weeks prior to desired plan commission meeting.

By signing below, I certify that the information included with this Conditional Use application is true and correct, to the best of my knowledge. Any agent signing below verifies that he/she has the consent of the owner to file the application.

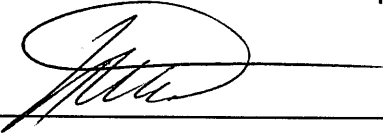

Owner's or Authorized Agent's Signature

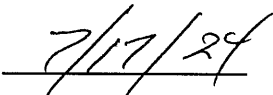

Date (DD/MM/YYYY)