



City of Fitchburg
 Planning/Zoning Department
 5520 Lacy Road
 Fitchburg, WI 53711
 (608) 270-4200

CONDITIONAL USE PERMIT APPLICATION

The undersigned owner, or owner's authorized agent, of property herein described hereby applies for a conditional use permit for the following described property:

1. Location of Property:

Street Address: 2825 INDEX ROAD FITCHBURG, WI 53713

Legal Description - (Metes & Bounds, or Lot No. And Plat): _____

***Also submit in electronic format (MS WORD or plain text) by email to: PLANNING@FITCHBURGWI.GOV

2. Current Use of Property: Liga Latinos and Latinas

3. Proposed Use of Property: Sports + Rec / Athletic w/ BEER/DRINKS

4. Proposed Development Schedule: _____

5. Zoning District: Business Highway

6. Future Land Use Plan Classification: _____

***Pursuant to Section 22-3(b) of the Fitchburg Zoning Ordinance, all Conditional Use Permits shall be consistent with the currently adopted City of Fitchburg Comprehensive Plan.

***Attach three (3) copies of a site plan which shows any proposed land divisions, plus vehicular access points and the location and size of all existing and proposed structures and parking areas. Two (2) of the three (3) copies shall be no larger than 11" x 17". Submit one (1) pdf document of the entire submittal to planning@fitchburgwi.gov.

Additional information may be requested.

Type of Residential Development (If Applicable): _____

No. of Dwelling Units by Bedroom: 1 BR 2 BR 3 BR 4 or More

No. Of Parking Stalls: Sat-Sun 7am-11pm

Type of Non-residential Development (If Applicable): _____

Proposed Hours of Operation: Sat + Sun 7am-11pm Mon-Fri 5pm-11pm No. Of Employees: 6 referee

Floor Area: 15,000 sq ft No. Of Parking Stalls: 30 plus other side of the building

Sewer: Municipal Private Water: Municipal Private

Current Owner of Property: WORLD WIDE WORLD, LLC

Address: 316 MONTE CRISTO CIRCLE VERONA, WI 53593 Phone No: 608 692 0007

Contact Person: DALE STICHA

Email: dale@sosonic.com

Address: 316 MONTE CRISTO CIRCLE VERONA, WI 53593 Phone No: 608-692-0007

Respectfully Submitted By: Dale A Sticha

Owner's or Authorized Agent's Signature

** It is highly recommended that an applicant hold at least one neighborhood meeting prior to submitting an CUP application to identify any concerns or issues of surrounding residents.

PLEASE NOTE - Applicants shall be responsible for legal or outside consultant costs incurred by the City. Submissions shall be made at least four (4) weeks prior to desired plan commission meeting.

For City Use Only: Date Received: _____ Publish: _____

Ordinance Section No. _____ Fee Paid: _____

Permit Request No. _____

The Latinos and Latinas League asks for its permission to sell beer at 2825 index rd Fitchburg wi 53713, the reason I ask permission is to be able to generate a little income to the place to help me pay for the rent of the salon and be able to cover the expenses with the mg and water bills. Also to keep the place in good condition.

Usually when a soccer team finish playing they usually drink something after the game either Gatorade, water, soda or beer. In the place we have barium rooms that we can use as a store to be able to install our things and thus be able to sell.

The Latino and Latino league wants to have its own indoor but for that we have to start from below and one day stop renting a place and be able to build our own place so that Latinos and other communities can participate in all the soccer turns.

The operation of how the beer would be sold would be in the morning at 9pm or 10pm as in any establishment. People just want to have a good time after a long work and many will play and have a drink and hang with friends I think it would not be a bad idea to do that. That is why I ask for permission to sell beer and so they also help me pay for the bills.

I am writing this letter explain what we are thinking in converting location 2825 Index Rd Fitchburg WI 53713, for this location we would like to used it for Sports recreation. We have a soccer organization that we have run outdoor for about 8 years now and we would like to expand out organization to an indoor location where we could practice and play all year around. We have a soccer field with all protection and regulations required to protect both players and spectators. In this place we want to have a small store where we can sell candies, snack, drinks like Gatorade, water, coca cola, Pepsi's, beer.

That way everything that we sell can help us for paying the rent of the place and bills like water bills, MG bill and try to keep the places in a good condition.

Every game would be 1 hr. in this hour we are thinking that we will have between 30 to 60 persons at the indoor location. This is including players, referees, and spectators.

- 1) 1 manager
- 2) Between 3-5 referees

Date & hours for club will be the following:

Training and tournaments hours

Monday – Friday

5pm – 11pm

Saturday – Sunday

7am -11pm

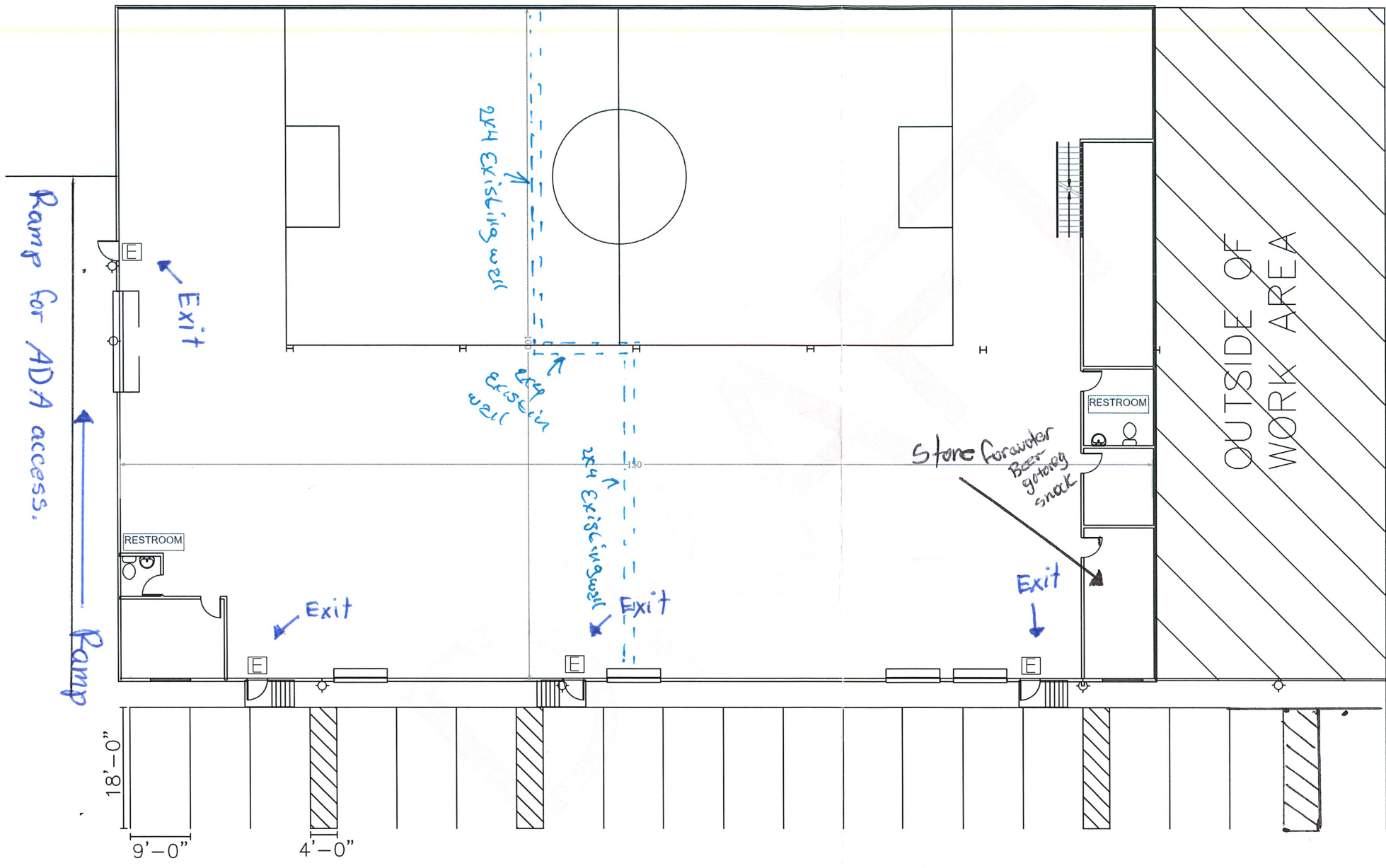

LEGEND

	EXTERIOR LIGHTING
	EXIT

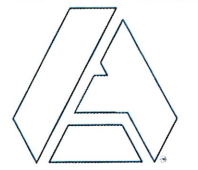
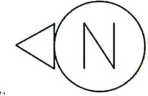

L.A. CONQUISTA LLC
 608.213.9785
 la.conquistallc@icloud.com

2825 INDEX RD
 FITCHBURG, WI

REV.00 10-14-2021
REV.01 10-28-2021
PREPARED FOR:
DRAFT
NO SCALE
NOT FOR CONSTRUCTION